



Inductive sensor NBB4-F1-UO

- 4 mm flush
- 2-wire AC/DC



Dimensions

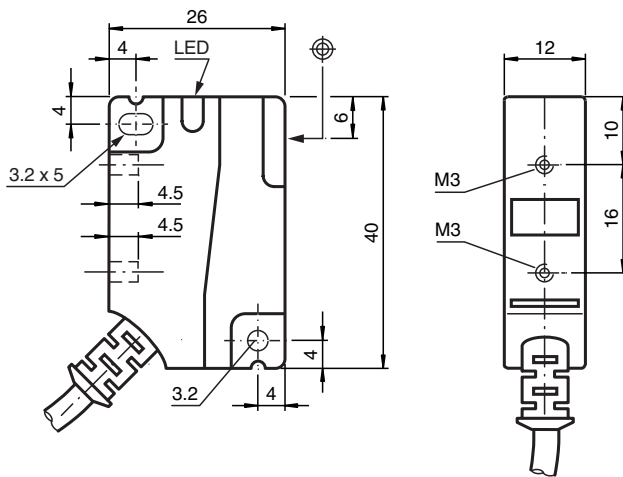

Technical Data

General specifications		
Switching function		Normally closed (NC)
Output type		Two-wire
Rated operating distance	s_n	4 mm
Installation		flush
Output polarity		AC/DC
Assured operating distance	s_a	0 ... 3.24 mm
Reduction factor r_{Al}		0.3
Reduction factor r_{Cu}		0.2
Reduction factor r_{304}		0.7
Output type		2-wire

Release date: 2022-05-18 Date of issue: 2022-05-18 Filename: 188296_eng.pdf

Refer to "General Notes Relating to Pepperl+Fuchs Product Information".

Pepperl+Fuchs Group
www.pepperl-fuchs.com

USA: +1 330 486 0001
fa-info@us.pepperl-fuchs.com

Germany: +49 621 776 1111
fa-info@de.pepperl-fuchs.com

Singapore: +65 6779 9091
fa-info@sg.pepperl-fuchs.com

PF PEPPERL+FUCHS

Technical Data

Nominal ratings

Operating voltage	U_B	20 ... 253 V AC/DC
Switching frequency	f	0 ... 25 Hz
Hysteresis	H	typ. 5%
Reverse polarity protection		reverse polarity protected
Short-circuit protection		pulsing
Voltage drop	U_d	≤ 7 V
Momentary current (20 ms, 0.1 Hz)		0 ... 2100 mA
Operating current	I_L	4 ... 250 mA AC 4 ... 100 mA DC
Off-state current	I_r	≤ 1.7 mA
No-load supply current	I_0	≤ 4 mA
Operating voltage indicator		LED, green
Switching state indicator		LED, yellow

Compliance with standards and directives

Standard conformity

Standards	EN 60947-5-2:2007 IEC 60947-5-2:2007
-----------	---

Approvals and certificates

UL approval	cULus Listed, General Purpose
CSA approval	cCSAus Listed, General Purpose
CCC approval	Certified by China Compulsory Certification (CCC)

Ambient conditions

Ambient temperature	-25 ... 70 °C (-13 ... 158 °F)
---------------------	--------------------------------

Mechanical specifications

Connection type	cable PVC , 2 m
Core cross section	0.5 mm ²
Housing material	PA
Sensing face	PA
Degree of protection	IP67
Tightening torque, fastening screws	Threading M3 max: 1.1 Nm

Connection

